



**WEXHAM COURT**  
PRIMARY SCHOOL

# Parent/Carer Newsletter



## Key Dates for Parents/Carers

- Friday 23rd October – last day of term
- Monday 2nd November - Back to School

## Important Information

Dear Parents & Carers,

I hope you had an enjoyable and relaxing weekend. Below are some important bits of information that I need to bring to your attention...

### **Inset Day**

Please be aware that we have cancelled Inset day on Monday 2<sup>nd</sup> November 2020. Therefore, children are expected to come back to school on Monday 2nd November. Unfortunately, due to Covid-19 we are unable to get a trainer in for the Teacher training session so the decision has been made to cancel the Inset day.

### **Staff cover**

It's been a good start to the term, but it is becoming quite difficult to cover classes if members of staff are shielding. It is not our intention to close before the half term, but should more staff need to shield, there may be a need to close down a particular year group. Should this happen, we will return to remote learning like we did during the summer holidays.

### **Year 6 Pupils - 11+ exam behaviour**

Well done to the Year 6 children who sat their 11+ exams on Friday 16th October for being extremely well behaved. We received a lovely message from St. Bernard's Grammar School praising the children for their excellent manners and good behaviour so a BIG well done to them! Check out the message below:

*Good afternoon,*

*This morning we invited approximately 50 pupils from Wexham Court Primary School to sit the 11+ with ourselves, together with pupils from a couple of other school. Most of the pupils were from your school. I just wanted to take the opportunity to say how well behaved your pupils were and you should be proud of how they conducted themselves during their time at St Bernard's. I was very impressed.*

*Kind regards,*

*Michelle Parker*

*Office Manager - St Bernard's Catholic Grammar School*



## School Streets

The proposed measures for the school street (Moat Drive) are that it will not be accessible from 8am - 9am & 3pm - 4pm on weekdays. Boulders will be placed at both ends of Moat Drive to stop any cars from accessing the road. Please can we kindly ask that you DO NOT park your cars or block any drive ways on Knolton Way and Hillersdon Road. Please refer to the image of the map below.

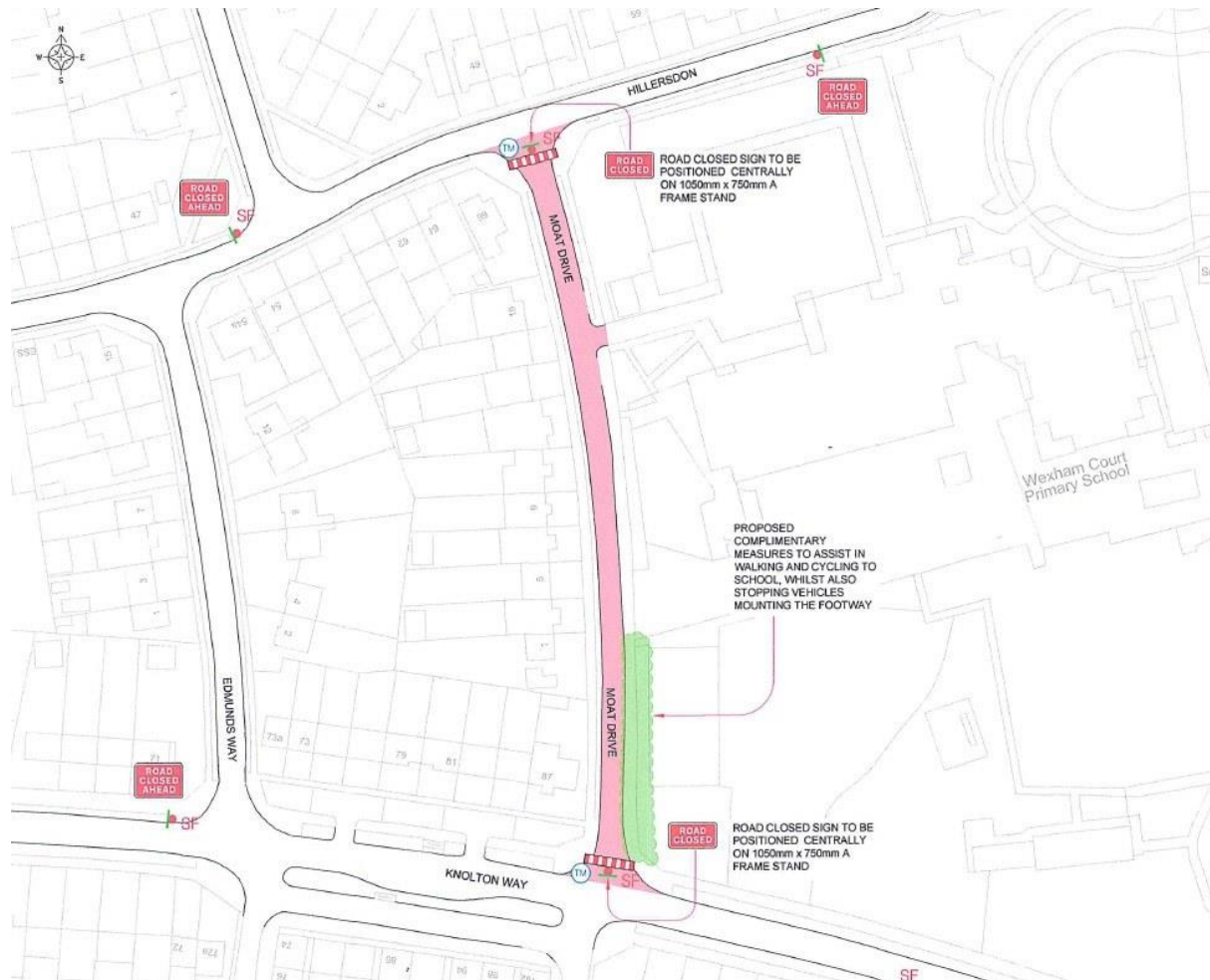

## End of Term

Terms ends on Friday 23rd October at normal time. The children will now return to school on Monday 2<sup>nd</sup> November (as mentioned above). Upon their return we will tighten up all our routines such as punctuality and attendance, uniform and homework. Please could all parents co-operate with us and ensure that children are on-time to School, wearing the correct uniform/PE kit and completing all homework that is set. Please refer to the School Uniform policy below.



### Litter around the School

I wanted to take this opportunity to say a special thank you to Erika Toth-Ignath and her friends for picking up litter around the School and keeping the environment clean. We are noticing Parents/Carers littering around the School and this is not setting a good example to the children! Please can I ask Parents/Carers to ensure that they throw their rubbish in the bins and not the floor.

As always, if there are any issues or concerns then please do not hesitate to contact the school.

Many thanks,  
*Navroop Mehat*

### Awards & Honours



## STARS OF THE WEEK

NURSERY	MORNING NURSERY Esmay	AFTERNOON NURSERY Esa	
RECEPTION	ENGLAND Sophie	WALES Taqi	SCOTLAND Haya
YEAR1	AUSTRALIA Harjot	TONGA Annam	FIJI Omer
YEAR2	CANADA Innaya	JAMAICA Muqadasa	MEXICO Logan
YEAR3	ECUADOR Insha	PERU	CHILE Bilal
YEAR4	MOZAMBIQUE Rihija	TANZANIA Zayan	MOROCCO Afan
YEAR5	HUNGARY Nourin	FRANCE Ilyas	ITALY Haitham
YEAR6	THAILAND Azaan	CHINA Aarondeep	NEPAL Lexie







## MATHLETICS

1 <sup>st</sup> PLACE	Mozambique	
	Australia	2 <sup>nd</sup> PLACE
3 <sup>rd</sup> PLACE	Morocco	
	Chile	LET'S IMPROVE

## HOUSE POINTS THIS WEEK

House Name	Points	Ranking
Copper Beech	927	2 <sup>nd</sup>
Horse Chestnut	919	3 <sup>rd</sup>
Majestic Oak	859	4 <sup>th</sup>
Sycamore	973	1 <sup>st</sup>







## Key Messages & Reminders

### Just so you don't forget...

#### School Applications

- Reception applications for September 2021 – online applications opened on Saturday 12<sup>th</sup> September and will close on Friday 15<sup>th</sup> January 2021.
- Secondary School applications for September 2021 (this applies to current Year 6 pupils) – online applications deadline is Saturday 31<sup>st</sup> October 2020. Please note that this is during the half term break so if you need any help you will need to contact us before half term starts.

#### Water Bottles & Lunches

A friendly reminder to all parents to remember to send their child/children in with their water bottle and lunch box (if they are having a packed lunch). We have had a few parent/children forgetting their lunches and water bottles and these are being dropped off throughout the day which is causing traffic within the office reception.

#### Lateness

When children are late to school, Parents must ensure that they sign the late book and not just leave their child at reception.

#### PE Kits

Can all Parents please ensure that children are wearing the correct PE kit to school. Please refer to the School uniform policy below.

### WEXHAM COURT PRIMARY SCHOOL SCHOOL UNIFORM

SCHOOL UNIFORM POLICY	
SWEAT SHIRT	Children should wear the school sweat shirt which is blue with a yellow emblem. No fleeces should be worn as the classrooms are sufficiently warm.
SHIRTS	Yellow polo shirts only.
SKIRTS & TROUSERS	Winter uniform: smart plain grey trousers, skirt or pinafores should be worn by boys or girls. Skirts should be of reasonable length. Black leggings or tights may be worn under skirts. Summer uniform: blue and white checked pinafores or grey shorts.
SHOES	Shoes should be smart, plain black and have a sensible heel height for moving around school. Trainers are NOT to be worn.
PE KIT	Plain white T-Shirt or polo shirt. Blue shorts, tracksuit bottoms or leggings. Plimssoles or trainers

*The School uniform can be purchased from Diffusion*



Please note that trainers are not to be worn in School except for P.E or non-uniform days. No jewellery is to be worn; with the exception of a pair of stud earrings or religious items, which must be removed or covered on P.E days.

All School uniform can be purchased from:  
**Diffusion,  
104-105  
Queensmere Shopping centre,  
Slough,  
SL1 1DQ**



**WEXHAM COURT**  
PRIMARY SCHOOL



*From all the staff here at Wexham Court Primary School,  
we hope you have a great week ahead!*